

JRV-TW800

Jarv

NMotion*FREE*

BLUETOOTH STEREO SPORT EARBUDS



U S E R S G U I D E

FEATURES

- Water / Sweat resistant
- True Wireless technology- No Wires!
- Comfortable lightweight in-ear design with ear hooks for added support
- High definition stereo sound with noise reduction
- Rechargeable battery with up to 6 hours of talk / music time
- Streams audio from any Bluetooth device
- On board controls and microphone

PACKAGE CONTENTS



- Jarv NMotion Free Bluetooth Stereo Sport Earbuds (Left+Right)
- Micro USB Y charging cable
- 3 sets of ear bud tips and silicone hooks (S,M,L)
- Carry case
- Users guide

EARBUD CONTROLS

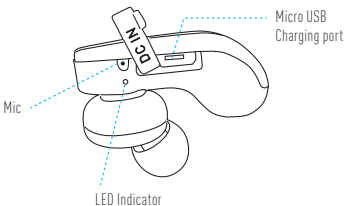
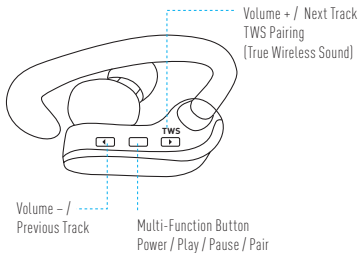

LED INDICATOR GUIDE

STATUS	INDICATOR
Power On	Blue Light
Power Off	Turns Red to power off
Charging	Red Light
Charging Complete	Blue Light
Bluetooth and TWS Pairing	Red and Blue Light flash alternately
Low Power	Flashing Red Light
Connected to Bluetooth	Blue LED flashing slowly
Standby Mode	Blue LED flashes every 5 seconds

GETTING STARTED

To use your Jarv NMotion Free Bluetooth Stereo Earbuds, please follow the steps below:

1. Ensure your Bluetooth Earbuds are fully charged.
2. Pair your Bluetooth Earbuds to a Bluetooth-enabled device prior to use. (See Pairing your Headset instructions)

Charging Your Headset

Your Jarv NMotion Free Bluetooth Stereo Earbuds come with a built-in rechargeable battery and a Micro USB Y charging cable. Charge fully before use. The battery indicator will turn red when charging and turn Blue once charging is complete. Initial charging time is approximately 2 hours.

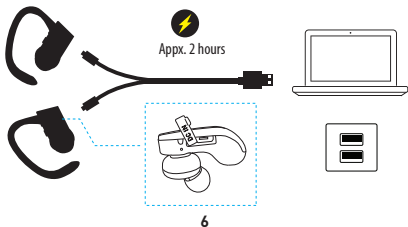

PAIRING YOUR HEADSET

Your Jarv NMotion Free Bluetooth Earbuds are True Wireless Earbuds and require that the earbuds be paired individually to your Bluetooth enabled device firstly and secondly to **each other** in order to achieve stereo sound from both.

PAIRING THE EARBUDS TO YOUR BLUETOOTH ENABLED DEVICE

1. Begin with both earbuds being powered off and fully charged
2. Place the earbuds and the mobile phone where they are easily viewable and no more than 3ft. apart.
3. Press and hold down the Pairing button (multi-function button) for approximately 8-9 seconds until the red and blue LED light flash alternately which indicates that you are in Pairing Mode.
4. Activate your mobile phone's Bluetooth pairing function, set the mobile phone to search for Bluetooth devices within range and select "**NMotion Free L**" and "**NMotion Free R**"

*This process needs to be done separately for each earbud **BOTH** Left and Right



100%



PRESS & HOLD

8-9seconds  

7



Once each earbud has successfully been paired to your device, the LED indicator will slowly flash Blue confirming your Bluetooth connection and your phone should show a connection to each of the earbuds (L+R) separately.

Please note you must now Pair the earbuds to each other.

PAIRING YOUR EARBUDS TO EACH OTHER FOR TRUE WIRELESS SOUND (TWS)

1. Press and hold down the button marked TWS for approximately 8-9 seconds until the red and blue LED light flash alternately which indicates that you are in pairing mode. This process needs to be done separately for each earbud (Left and Right).

Once both earbuds are successfully paired to each other you will hear a beeping sound confirming the True Wireless pairing.



NOTE: In the event that you cannot get the earbuds to pair properly, please delete the devices from your Bluetooth connection and begin at Step 1.

POWERING ON THE HEADSET

Powering On the Headset

Press and hold down the Multi-Function button for 3 seconds until a blue light appears

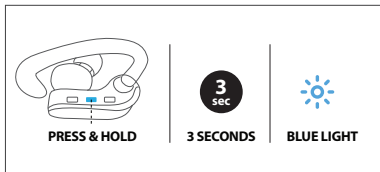

Powering Off the Headset

Once powered on, Press and hold down the Multi-Function button for 3 seconds until a red light appears.

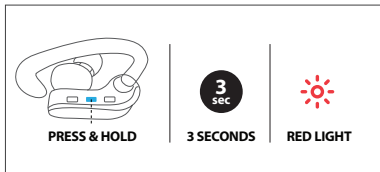

WEARING YOUR HEADSET

The Left / Right indicator is located on the inside of the Earbuds and on the ear hooks

Because everyone's ears are different, be sure to try all sizes of earbud tips. Only with the right size earbud tips will you enjoy a snug fit & premium sound quality



Adjust ear tip size if necessary



**Adjust earhook to fit
securely around the ear**

CALL MODE

Please note that in Call Mode only the **Left OR Right** earbud can be supported.

Answering a Call

Short Press the Multi-Function button once to accept the call, or answer the call normally via your mobile phone.

Rejecting a Call

Press and hold the Multi-Function button for 2 seconds to reject the incoming call.

Ending a Call

Short Press the Multi-Function button to end the call or end the call directly from your mobile phone.

Redialing a Call

Press the Multi-Function button twice to redial the last dialed phone number on your mobile phone.

Mute/Resume Call

During a call, press and hold the "Volume -" and "Volume +" button for 2 seconds to mute the call, follow the steps again to resume the call.

MUSIC MODE:

Please note in Music mode, both earbuds can work together simultaneously.

Adjusting the Volume

Short Press the Volume + to increase volume or Volume - to decrease volume. You can also adjust the volume on your handset or device

Play/Pause Music

Once connected, Press the Multi-Function button once to play music. Short Press the Multi-Function button to pause music.

Previous Track

Press and hold the "Volume -" key to select the next track.

Next Track

Press and hold the "Volume +" key to select the previous track.

Connection with the Last Paired Device

When powered on, the earbuds will automatically connect with the last successfully paired device. In Music mode, True Wireless pairing will also automatically connect with the last successfully paired device.

Resetting your Bluetooth device

Turn the headset on, simultaneously press and hold down the "Volume -" and "Volume +" button for 5 seconds or until you hear a voice prompt confirming the reset. This will clear all settings/memory. The headset will then automatically enter Pairing Mode.

TROUBLESHOOTING

If you are unable to connect your headset and mobile phone, please try the following:

Ensure that your headset is fully charged and powered on.

Ensure that the headset is paired with your mobile phone.

Ensure that your mobile phone's Bluetooth feature is activated.

Please refer to your mobile phone user's guide for specific instructions.

Ensure that the headset is within a 30 ft. range of your mobile phone and that there are no obstructions, such as walls or other electronic devices, between the two.

If the above steps do not solve your problem, please remove your mobile phone battery for a short time and recharge the headset.

Repeat the troubleshooting sequence.

If you are experiencing Bluetooth connection issues - KEEP THE MUSIC DEVICE AT OR ABOVE WAIST LEVEL ON YOUR RIGHT SIDE, THE SAME SIDE AS THE HEADPHONE ANTENNA. Your body is 80% water. Water blocks low power radio signal like Bluetooth. In the absence of nearby ceilings for signal bounce, your body can block the signal between the music device and the headphones. When outdoors or at the gym the use of armbands or wrist-worn music players are recommended. Having your music player in your pants pocket below waist level may produce varied results as your body can get between the music device & headphones.

WARRANTY

At Jarv, we are dedicated to making the best quality product. To back this up, your Jarv Bluetooth earphones are warranted for One (1) full year from the date of purchase.

Please visit our website **www.jarvmobile.com** for more details Or Email us at: **customerservice@jarvmobile.com**

SAFETY INFORMATION

Check local laws regarding the use of mobile phones and headsets while driving.

If you use the headset while driving, ensure that your attention and focus remains on the road and you drive in a responsible and safe manner.

Never allow children to play with the headset, as the small parts may be a choking hazard.

Observe all signs that require an electrical device or RF radio product to be switched off in designated areas. These could include hospitals, airplanes, blasting areas, and potentially explosive environments.

Never mount or store your headset over an air bag deployment area, a serious injury may result when the air bag deploys.

Do not open or mutilate the built-in battery.

Dispose of batteries according to local regulations. Do not dispose as household waste.

Care and Maintenance of Your Headset

i. Consider turning your headset off before placing it in your pocket or bag. If the Power button is accidentally activated, your mobile phone may place an unintended call. Your Bluetooth

headset comes with a premium quality carry pouch for your convenience.

- ii. Do not expose the headset to liquid, moisture or humidity, as it is not waterproof.
- iii. Do not use abrasive cleaning solvents to clean the headset.
- iv. Do not expose the headset to extreme temperatures. The best storage temperature range is from 40-80 F, otherwise, the life of the headset will be affected.
- v. Do not dispose of the headset in fire as it this may result in an explosion.
- vi. Do not bring your headset into contact with sharp objects as this will cause scratches and can damage the headset.
- vii. Do not attempt to disassemble the headset, as it does not contain serviceable components.
- viii. If you do not use the headset for long periods, be sure to store it in a dry place, free from extreme temperature conditions and dust. For best protection, use the included storage pouch.

PRODUCT SPECIFICATIONS

Basic Specs:

Model No. JRV-TW800

Product Size: 1.9X1.6X1.3 inches

Product Weight (bare): 0.42 oz. X 2

Charging Current: 100mA

Charging Time - Less than 2 hours

Bluetooth Version: Bluetooth 4.2

Wireless Range: 33 feet

Input voltage: Micro USB DC 5V

Battery:

DC Battery power: 3.7V 95mAh Built-in rechargeable lithium battery

Battery life: Up to 6 hours of Talk/Music Time

Actual performance may vary due to the user's habits, different modes of operation, and mobile phone settings. This manual is for reference purposes only. The specifications and design of the headset may change without prior notice. Actual product may differ slightly from the image on the packaging

WARNING AND PRECAUTIONS

WARNING: To prevent fire or shock hazard, do not expose this unit to rain or moisture.

WARNING: Do not place this unit directly onto furniture surfaces with any type of soft, porous, or sensitive finish. As with any rubber compound made with oils, the feet could cause marks or staining where the feet reside. We recommend using a protective barrier such as cloth or a piece of a glass between the unit and the surface to reduce the risk of damage and/or staining.

WARNING: Lithium batteries, like all rechargeable batteries are recyclable and should be recycled or disposed of in normal household waste. Contact your local government for disposal or recycling practices in your area. They should be incinerated since they might explode.

NOTE: This device uses an internal rechargeable lithium-ion battery that should last the lifetime of the device. If you suspect your battery may be dead after several attempts to charge, please visit www.jarvmobile.com for support. Never disassemble the unit or attempt to remove the battery as that could cause leakage of an electrolyte substance

FCC WARNINGS

Warning: Changes or modifications to this unit not expressly approved by the party responsible for compliance could void the user's authority to operate the equipment.

NOTE: This equipment has been tested and found to comply with the limits for a Class B digital device, pursuant to Part 15 of the FCC rules. These limits are designed to provide reasonable protections against harmful interference in a residential installation. This equipment generates, uses, and can radiate radio frequency and, if not installed and used in accordance with the instructions, may cause harmful interference to radio communications.