

# Jarv

# Mach<sup>1</sup>

**BLUETOOTH**  
STEREO EARBUDS  
BTHL-750



**USERS GUIDE**

## FEATURES

- Wireless technology using Bluetooth 4.1 A2DP
- Water / sweat resistant
- Comfortable lightweight in-ear design with ear hooks for added support
- High definition stereo sound with noise reduction
- Rechargeable battery with up to 5 hours of talk/music time
- Stream audio from any Bluetooth device
- On board controls has built in volume, play, pause and answer functionality
- Tangle free cable

## PACKAGE CONTENTS



- Jarv Mach 1 BTHL-750 Bluetooth Stereo Earbuds
- Micro USB charging cable
- 3 sets of ear bud tips (S,M,L)
- Carry pouch
- Users guide

## CONTROL UNIT

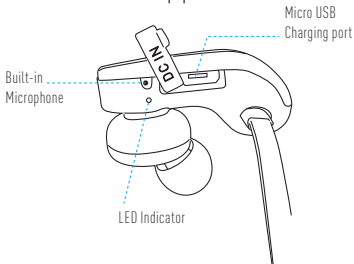
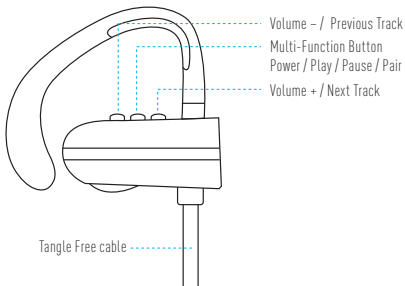

## LED INDICATOR GUIDE

### STATUS

### INDICATOR

---

Power On

Blue Light

---

Power Off

Turns Red to power off

---

Charging

Red Light

---

Charging complete

Blue Light

---

Pairing Mode

Red and Blue Light flash alternately in pairing mode

---

Low Power

Flashing Red Light

---

Connected

Blue LED flashes twice every 7 seconds

---

Standby Mode

Blue LED flashes every 5 seconds

# GETTING STARTED

To use your Jarv Mach1 Bluetooth Stereo headset, please follow the steps below:

1. Ensure your Bluetooth headset is fully charged.
2. Pair your Bluetooth headset to a Bluetooth-enabled device prior to use. (See Pairing your Headset instructions)

## Charging Your Headset

Your Mach1 headset comes with a built-in rechargeable battery and a Micro USB charging cable. Charge fully before use. The battery indicator will turn red when charging and turn Blue once charging is complete. Initial charging time is approximately 2 hours.

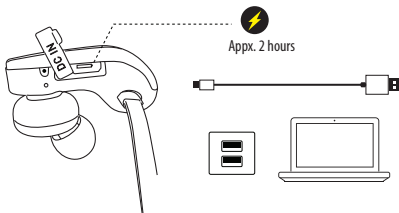

# PAIRING YOUR HEADSET

In order to use your Jarv Mach1 Bluetooth Stereo Earbuds with a Bluetooth-enabled device, you will first need to pair the two.

## PAIRING WITH YOUR DEVICE

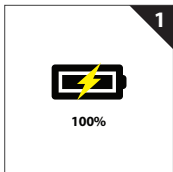

1. Begin with the headset being **powered off and fully charged**
2. Place the headset and the mobile phone where they are easily viewable and no more than 3ft. apart.
3. Press and hold the Pairing button (multi-function button) for approximately 8-9 seconds until the red and blue light

flash alternately which indicates that you are in Pairing Mode.

4. Activate your mobile phone's Bluetooth pairing function.
5. Set the mobile phone to search for Bluetooth devices within range and select "**Jarv Mach 1**" from the list of devices shown.
6. When successfully paired the LED indicator will flash Blue twice every 7 seconds

(If you are prompted for a Passcode enter "0000" and press "ok" to pair the headset with your mobile phone)





# POWER ON / OFF

## Powering on the Headset

Press and hold down the Multi-Function button for 3 seconds until a blue light appears.

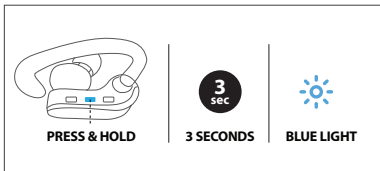

## Powering Off the Headset

Once powered on, Press and hold down the Multi-Function button for 3 seconds until a red light appears.

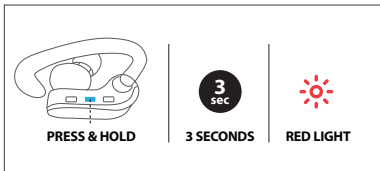

## WEARING YOUR HEADSET

The Left / Right indicator is located on the inside of the Earbuds.

Because everyone's ears are different, be sure to try all sizes of earbud tips. Only with the right size earbud tips will you enjoy a snug fit & premium sound quality



**Adjust ear tip size if necessary**

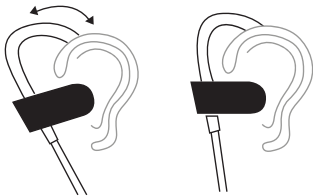

**Adjust earhook to fit  
securely around the ear**

## CALL MODE

Answering a Call	Short Press the Multi-Function button once to accept the call, or answer the call normally via your mobile phone.
Rejecting a Call	Press and hold the Multi-Function button for 2 seconds to reject the incoming call.
Ending a Call	Short Press the Multi-Function button to end the call or end the call directly from your mobile phone.
Redialing a Call	Press the Multi-Function button twice to redial the last dialed phone number on your mobile phone.
Mute/Resume Call	During a call press and hold the "Volume -" and "Volume +" button for 2 seconds to mute the call, follow the steps again to resume the call.

## MUSIC MODE

- |                      |  |
|----------------------|--|
| Adjusting the Volume | Short Press the Volume + to increase volume or Volume - to decrease volume. You can also adjust the volume on your handset or device |
| Play/Pause Music     | Once connected, Press the Multi-Function button once to play music. Short Press the Multi-Function button to pause music.            |
| Previous Track       | Press and hold the "Volume -" key to select the next track.  |
| Next Track           | Press and hold the "Volume +" key to select the previous track.  |

## Connection with the Last Paired Device

When powered on, the headset will automatically connect with the last successfully paired device. If the connection is successful, it enters standby mode. If the devices fail to connect within 5 minutes after the pairing has been initiated, the headset will turn off automatically.

## Multi-Connection Mode

1. Pair your first Bluetooth device to the Jarv Mach 1 by pressing down the multi-function button for approximately 7-8 seconds until the blue/ red light flash alternately and select "Jarv Mach 1" from your list of Bluetooth devices (Refer to "PAIRING WITH YOUR DEVICE" for more details ).  
Once the Jarv Mach 1 headset is Connected, **Power OFF** the headset.
2. Pair the second Bluetooth device by pressing down on the multi-function button for approximately 7-8 seconds to enter Pairing mode again. Select "Jarv Mach 1" from the list of Bluetooth devices to connect.
3. Go back to the first Bluetooth device, go to your list of Bluetooth devices, select "Jarv Mach 1" to connect it.
4. Both Bluetooth devices should now be connected to your "Jarv Mach 1"

\*Please make sure that your headset is fully charged before using the Multi-Connection mode

## **Resetting your Bluetooth device**

Turn the headset on, simultaneously press and hold down the "-" and "+" button for 5 seconds or until you hear an audible beep confirming the reset. This will clear all settings/memory.

## **Troubleshooting**

If you are unable to connect your headset and mobile phone, please try the following:

- Ensure that your headset is fully charged and powered on.
- Ensure that the headset is paired with your mobile phone.
- Ensure that your mobile phone's Bluetooth feature is activated. Please refer to your mobile phone user's guide for specific instructions.
- Ensure that the headset is within a 10 meter (30 ft.) range of your mobile phone and that there are no obstructions, such as walls or other electronic devices, between the two.
- If the above steps do not solve your problem, please remove your mobile phone battery for a short time and recharge the headset. Repeat the troubleshooting sequence.

If you are experiencing Bluetooth connection issues - KEEP THE MUSIC DEVICE AT OR ABOVE WAIST LEVEL ON THE SAME SIDE AS THE HEADPHONE ANTENNA WHICH IS LOCATED IN THE CONTROL. Your body is 80% water. Water blocks low power radio signal like Bluetooth. In the absence of nearby ceilings for signal bounce, your body can block the signal between the music device and the headphones. When outdoors or at the gym the use of armbands or wrist-worn music players are recommended. Having your music player in your pants pocket below waist level may produce varied results as your body can get between the music device & headphones.

## **Warranty**

At Jarv, we are dedicated to making the best quality product. To back this up, your Jarv Bluetooth earphones are warrantied for One (1) full year from the date of purchase. Please visit our website **[www.jarvmobile.com](http://www.jarvmobile.com)** for more details

Or Email us at:

**[customerservice@jarvmobile.com](mailto:customerservice@jarvmobile.com)**

## **Safety Information**

Check local laws regarding the use of mobile phones and headsets while driving.

If you use the headset while driving, ensure that your attention and focus remains on the road and you drive in a responsible and safe manner.

Never allow children to play with the headset, as the small parts may be a choking hazard.

Observe all signs that require an electrical device or RF radio product to be switched off in designated areas. These could include hospitals, airplanes, blasting areas, and potentially explosive environments.

Never mount or store your headset over an air bag deployment area, a serious injury may result when the air bag deploys.

Do not open or mutilate the built-in battery.

Dispose of batteries according to local regulations. Do not dispose as household waste.

## **Care and Maintenance of Your Headset**

i. Consider turning your headset off before placing it in your pocket or bag. If the Power button is accidentally activated, your mobile phone may place an unintended call. Your Bluetooth headset comes with a premium quality carry



pouch for your convenience.

ii. Do not expose the headset to liquid, moisture or humidity, as it is not waterproof.

iii. Do not use abrasive cleaning solvents to clean the headset.

iv. Do not expose the headset to extreme temperatures. The best storage temperature range is from 40-80 F, otherwise, the life of the headset will be affected.

v. Do not dispose of the headset in fire as it this may result in an explosion.

vi. Do not bring your headset into contact with sharp objects as this will cause scratches and can damage the headset.

vii. Do not attempt to disassemble the headset, as it does not contain serviceable components.

viii. If you do not use the headset for long periods, be sure to store it in a dry place, free from extreme temperature conditions and dust. For best protection, use the included storage pouch.

## **Product Specifications**

### **Basic Specs:**

Model No. BTHL-750

Product Size: 27.2 X 1.9X 1.2 inches

Product Weight: 0.78 oz.

Charging Voltage: DC 5V 500mA

Charging Time - Less than 2 hours

Bluetooth Version: Bluetooth 4.1 A2DP

Wireless Range: 33 feet

### **Battery:**

DC Battery Power: 120 maH Built-in rechargeable lithium battery

Battery Life: Up to 5 hours of Talk/Music Time

Stand-by Time: Up to 96 hours

Actual performance may vary due to the user's habits, different modes of operation, and mobile phone settings.

This manual is for reference purposes only. The specifications and design of the headset may change without prior notice. Actual product may differ slightly from the image on the packaging

## Warning and Precautions

**WARNING:** To prevent fire or shock hazard, do not expose this unit to rain or moisture.

**WARNING:** Lithium batteries, like all rechargeable batteries are recyclable and should be recycled or disposed of in normal household waste. Contact your local government for disposal or recycling practices in your area. They should be incinerated since they might explode.

**NOTE:** This device uses an internal rechargeable lithium-ion battery that should last the lifetime of the device. If you suspect your battery may be dead after several attempts to charge, please visit [www.jarvmobile.com](http://www.jarvmobile.com) for support. Never disassemble the unit or attempt to remove the battery as that could cause leakage of an electrolyte substance

## FCC Warnings

**WARNING:** Changes or modifications to this unit not expressly approved by the party responsible for compliance could void the user's authority to operate the equipment.

**NOTE:** This equipment has been tested and found to comply with the limits for a Class B digital device, pursuant to Part 15 of the FCC rules. These limits are designed to provide reasonable protections against harmful interference in a residential installation. This equipment generates, uses, and can radiate radio frequency and, if not installed and used in accordance with the instructions, may cause harmful interference to radio communications.